

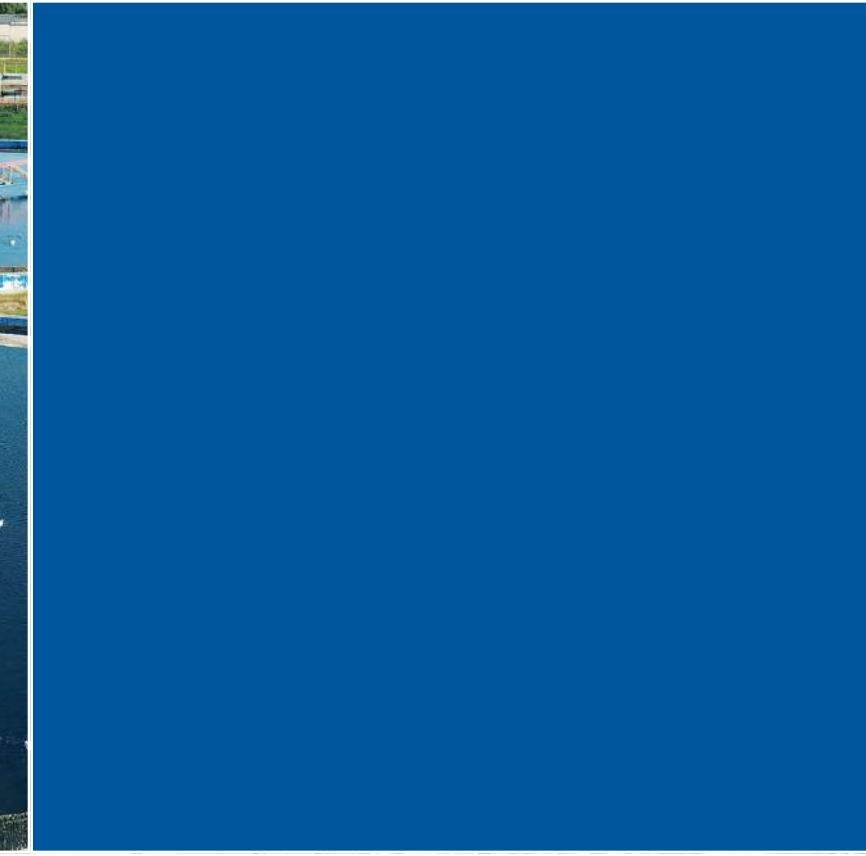

MOTOR SHARK



Industrial Motors

- Comercial Motors and Appliance
- Automation
- Digital and Systems
- Energy
- Transmission and Distribution
- Paints

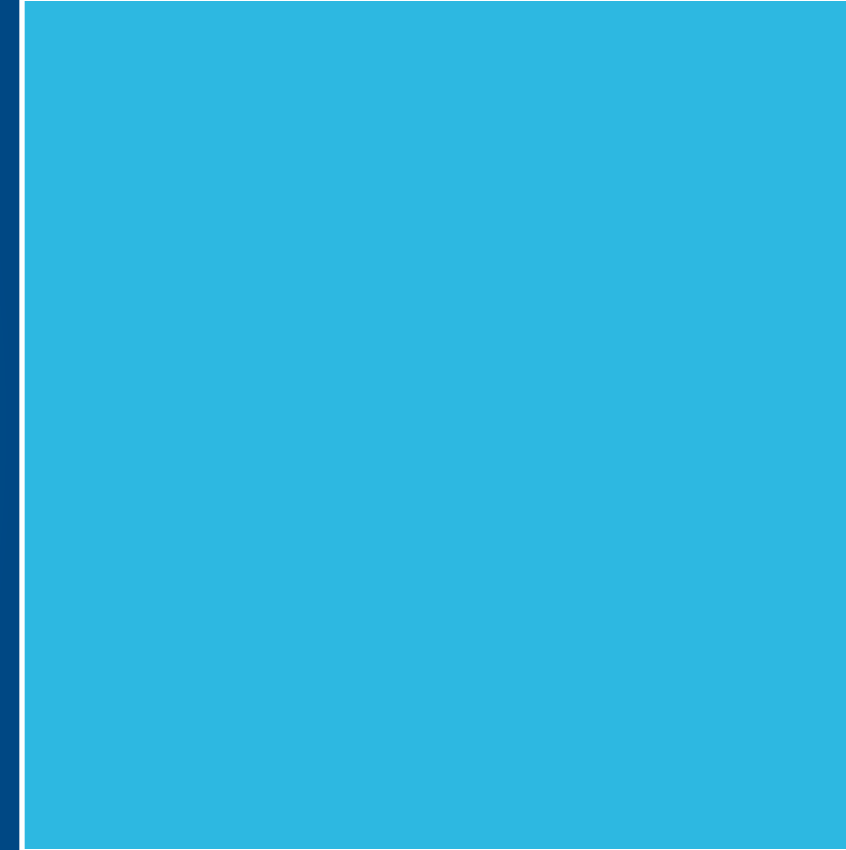

Component Design

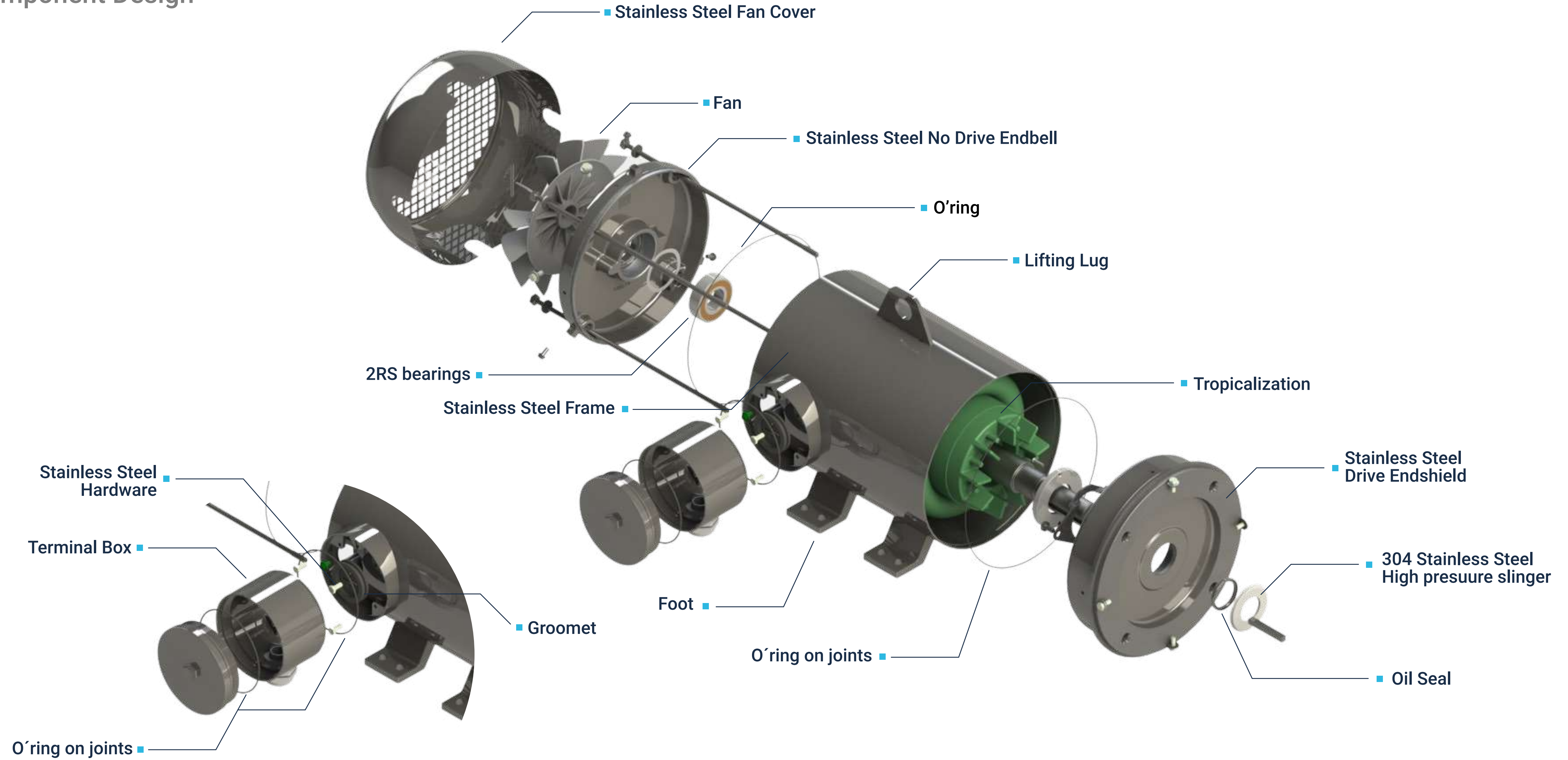

Competitive Advantages

Welded Lifting Provision

Hygienic design with no gaps—easy to clean and prevents residue buildup.



2RS Bearings

Double-sealed bearings extend life and reduce maintenance needs.



Tropicalization

Protects stator and rotor from moisture and corrosion for longer motor life.



304 Stainless Steel Slinger

Prevents water and contaminants from entering during cleaning or water jets.

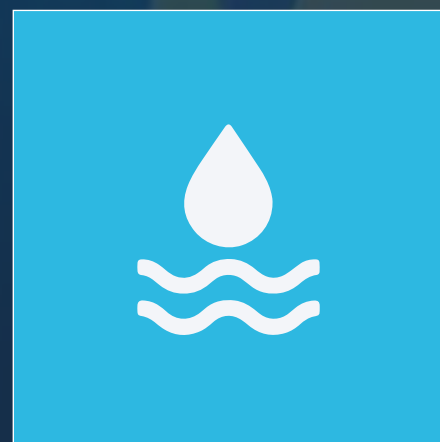

Welded Feet Design

Special feet design prevents residue buildup and enhances cleaning efficiency.

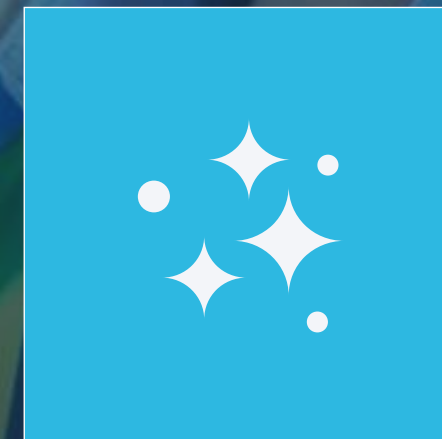

O' Ring Seals

Ensures superior sealing, blocking water and dust ingress.

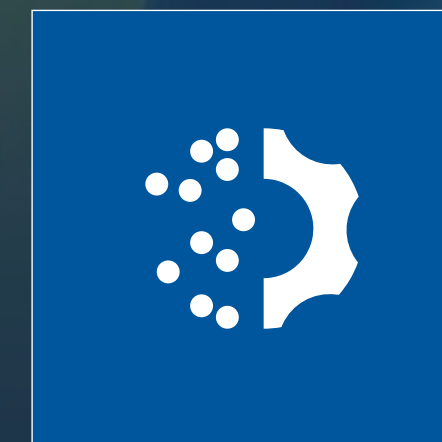

Round Terminal Box

Smooth, rounded surface avoids dirt accumulation and simplifies cleaning.





Features

Standard Features:

- Output: 0.33 HP to 20 HP
- Frames: 56 up to 254/6TC
- Number of poles: 2 up to 6
- Certifications: CSA/UL/CE
- Efficiency: NEMA Premium @ 60hz and IE3 for 50hz
- Voltage: 230/460//190-220/380-415
- Service Factor: 1.15
- Mounting: F1 (Footless and Foot Mount)
- Flange: C-Face
- Enclosures: TEFC and TENV
- Insulation Class: F (Class H available under request)
- Degree of protection: IP66
- Duty: Continuous
- Shaft: Stainless Steel 300 Series

Unique Standard Features:

- 360 degrees rotatable terminal box
- Welded Terminal Box
- Independent Feet
- Four T-drains in each endplate
- O'rings in end shields
- Made in North America
- Polished stainless steel finish
- Colored Leads

Optional:

- SGR shaft grounding ring
- Class H

Applications

Stainless steel washdown motors designed for applications where there is constant cleaning with chemicals and high-pressure water jets.



Water Treatment
Plants



Food Processing



Corrosion Resistant
Equipment



Pharmaceutical
Manufacturing

Other applications that require
extreme cleanliness and
frequent washdowns



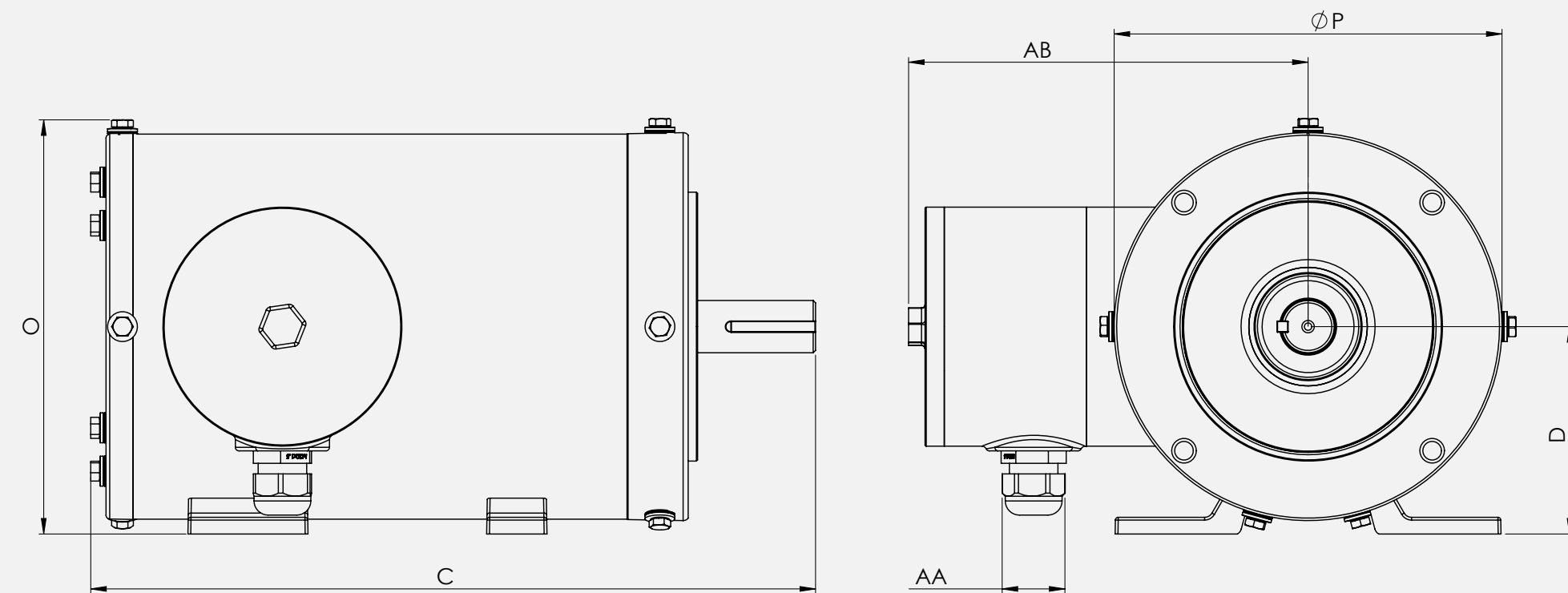
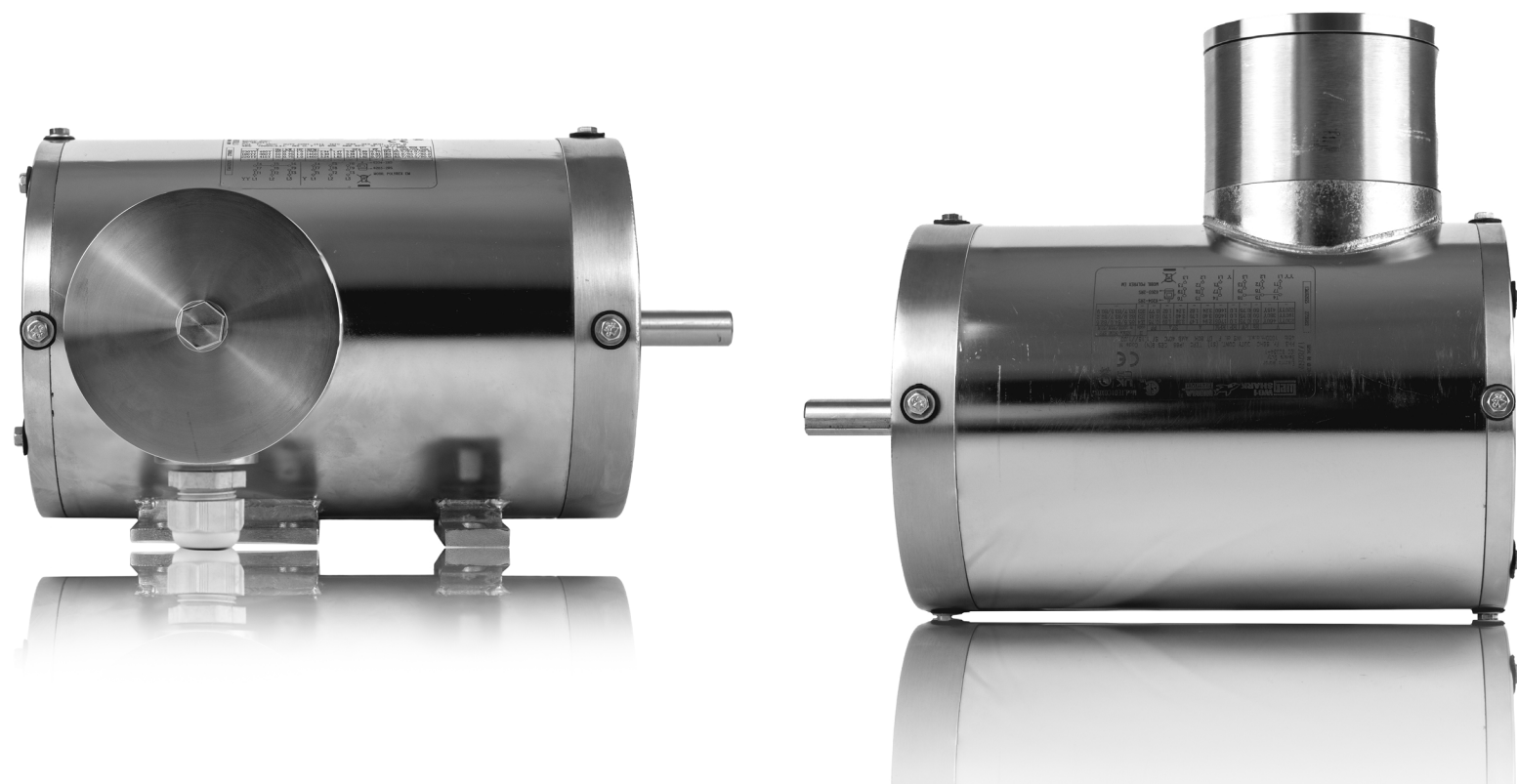

TENV (SIN VENTILADOR)

Dimensions mm/in	Frame 56	Frame 56H	Frame 143/5T
ØP	163.8/6.44	163.8/6.44	163.8/6.44
AB	169.9/6.68	169.9/6.68	169.9/6.68
O	165.6/6.51	165.6/6.51	165.6/6.51
D	88.15/3.47	88.15/3.47	88.15/3.47
C	356.5/14.03	356.5/14.03	358.2/14.1
ØAA	1/2"	1/2"	3/4"
Front Bearing	6204 RS	6204 RS	6205 RS
Front Bearing	6203 RS	6203 RS	6203 RS



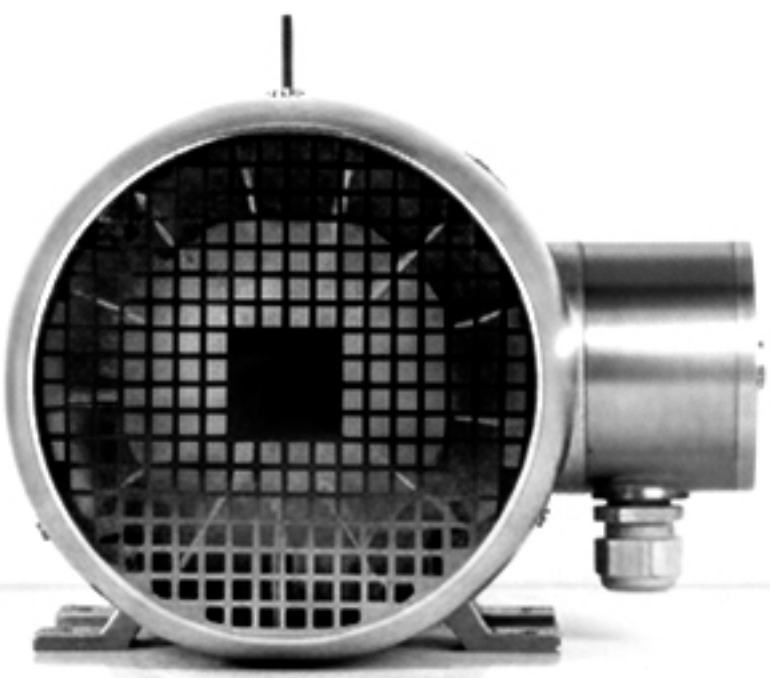

TEFC (CON VENTILADOR)

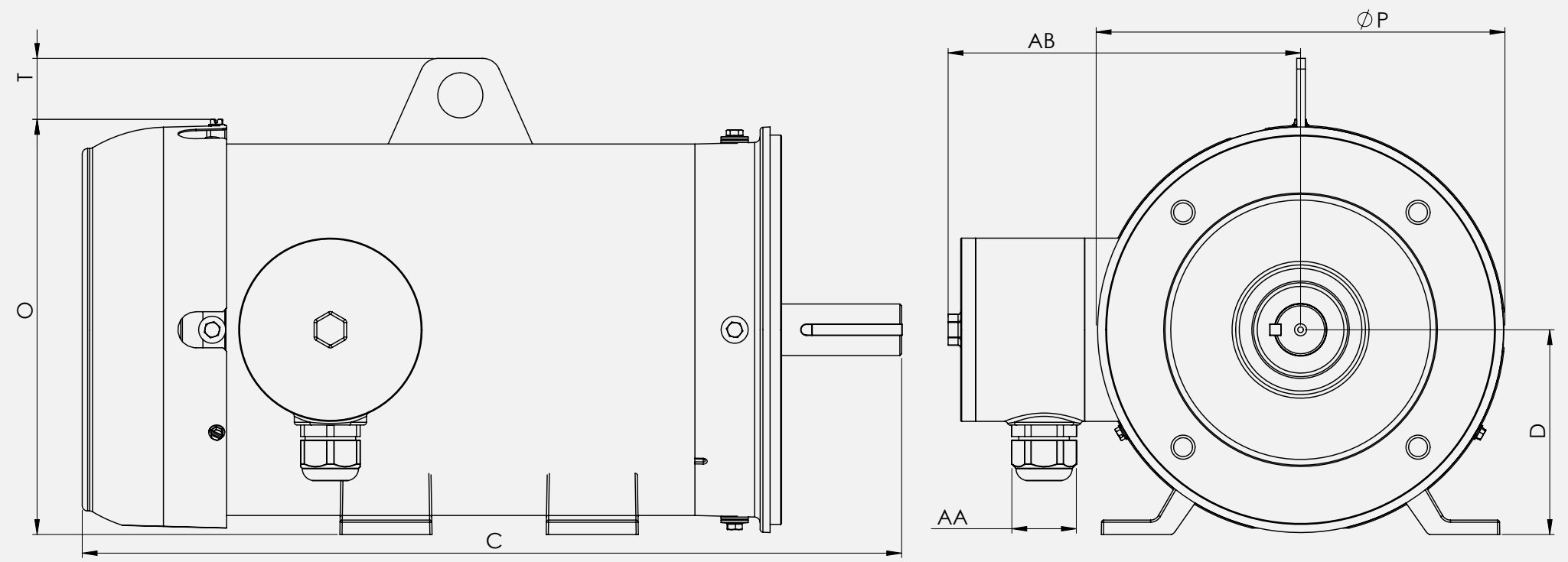

Dimensions mm/in	Frame 56	Frame 56H	Frame 143/5T	Frame 143/5T	Frame 143/5T	Frame 143/5T
ØP	164.85/6.49	164.85/6.49	164.85/6.49	224.95/8.85	247.8/9.75	292.03/11.49
AB	169.9/6.68	169.9/6.68	169.9/6.68	195.3/7.68	291.1/8.62	253.8/9.99
O	184.2/7.26	184.2/7.26	184.2/7.26	264.1/10.39	304.4/11.98	364.3/14.34
T	-	-	-	33.84/1.33	33.31/1.31	42.06/1.65
D	88.15/3.47	88.15/3.47	88.15/3.47	113.55/4.47	132.6/5.22	158/6.22
C	402/15.82	402/15.82	402.7/15.89	544/21.41	620/24.4	644/23.35
ØAA	1/2"	1/2"	3/4"	3/4"	1"	1 3/4"
Front Bearing	6204 RS	6204 RS	6205 RS	6206 RS	6208 RS	6209 RS
Front Bearing	6203 RS	6203 RS	6203 RS	6205 RS	6206 RS	6208 RS

The scope of WEG solutions is not limited to the products and solutions presented in this brochure.

Contact WEG for information on additional products and solutions.

To learn about WEG's operations worldwide, visit our website.



www.weg.net



 55 5321 4231

 wegmex@weg.net

 Jorobas Tula Highway Km. 3.5
Block 5, Lot 1 Huehuetoca Industrial Park,
State of Mexico Zip Code 54680.